

just ask, Jo-Ann



more projects, tips & techniques at Joann.com®

free

CARE & REPAIR

- **KNIT CUFFS & COLLARS:** Replace worn or frayed items so shirts look new again.
- **SHIRT AND PANT EXPANDERS:** Quick no-sew short cuts for more breathing room.
- **COLLAR STAYS:** For men's dress shirts, keeps points flat.
- **POCKET REPAIRS & REPLACEMENTS:** Prolongs clothing investment.



- **SEWING TABLE ASSISTANT:** 38"-wide padded work surface protects table top, with plenty of pockets to stash tools (not included).



Knit Pickers repair fine sweaters and knits by pulling snags through to the inside of the garment. Don't cut the loop or it will unravel and make a hole.

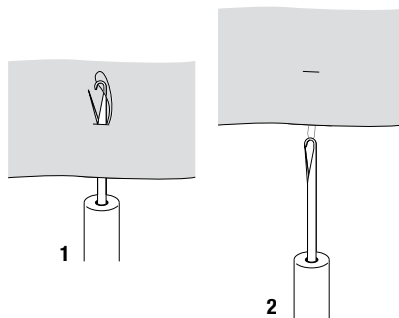

Create a secret travel pocket that can be worn garter-style by sewing an elastic band to the top of a **Sew-In Side Pocket**.

- **TAILOR'S HAM:** Helps with pressing curved areas of clothing for a better fit and professional finish.
- **SEAM ROLL:** Helps prevent crease or impression marks while pressing.

IRONING

Premium boards & covers for faster, better results. Boards feature sturdy frames, with best heat-reflecting, scorch-resistant cover & ultra-plush padding for a smooth, wrinkle-free finish.

- **SLEEVE BOARD:** Stand locks in place, folds flat for storage.
- **TABLETOP BOARD:** Fits on bed or table, hook for hanging.
- **IRONING BLANKET:** Iron anywhere! Just fold and go! Thick padding, heat-reflective cover & no-slip backing. Ideal for dorms, small spaces or traveling.
- **PREMIUM REFLECTIVE FINISH COVER:** Non-stick, scorch-resistant cover reflects heat back up through garment for faster wrinkle removal & crease setting.
- **COTTON CANVAS COVER:** Thick fabric retains heat & allows steam through.



Sewing Guide Board Cover fits over regular cover for projects. A sewing basket keeps ironing gear handy.



Thermal Thimbles protect fingers when pressing. For easier wrinkle removal on cotton or linen, fill **Spray Bottle** with distilled water and spray before pressing.

PREMIUM IRONING ACCESSORIES

- **SILICONE IRON REST:** Heat-resistant pad protects surfaces from hot iron.
- **SHEER PRESSING CLOTH:** Lay on top of garment to prevent unwanted shine.
- **NON-STICK PRESSING SHEET:** Use like a press cloth, keeps craft glue & paint off iron.
- **FELTED PADDING:** Add more padding when the old one gets compressed and hard.
- **COVER FASTENERS:** 4 clips prevent slipping & keep cover wrinkle-free.
- **IRON CLEANER:** Removes starch & meltdowns from iron so it glides smoothly. Also cleans curling irons and hair straighteners.

Courtesy of Prym Consumer USA

Please read and follow all manufacturers' instructions for all tools and materials used. Provide adult supervision if children participate in this project. ©2012 Jo-Ann Stores, Inc.

JOANN
fabric and craft stores®



GREAT STAIN REMOVERS

- **STAIN BE GONE GEL BRUSH:** Great for tough ground-in stains.
- **STAIN BE GONE ON THE GO:** 3 pack of instant stain remover pens, for car, bag, briefcase & desk.



Pre-treat stains when you remove the soiled item using **Stain Be Gone Gel Brush**. Spot-treated clothes can sit for up to a week before laundering.



- **COLOR ABSORBER:** Dye catcher sheets pick up excess dye in the washer. Use with new clothes or mixed colors.

- **GEL BLEACH PEN:** Removes stains on clothing without yellowing.



LAUNDRY AIDS



- **DRYER BALLS:** Lifts and separates items during drying cycle to fluff, reduce wrinkles and shorten drying time. Use 4 to 6 balls.
- **DRYING/CLOTHES RACK:** 64" tall, fold up for travel or easy storage. Holds up to 33 garments.



- **STATIC REMOVAL BALLS:** Economical, reusable balls drop in dryer with wet clothing & prevent static, even on over-dried items. Use with synthetic fabrics such as athletic gear and lingerie. Hypo-allergenic, safe for all fabrics.

As dirty clothes are removed, sort them by colors (whites, lights and darks) into a divided cart or separate baskets. Eliminates double handling!

LAUNDRY WASH BAGS: Wash & dry small or delicate items in mesh bags to keep them together & avoid damage.

- **SWEATER BAG**
- **4-POCKET BAG**
- **LINGERIE BAGS**



- **SNEAKER BAG** fastens securely to your dryer door, holding sneakers to keep them from clanging. Also good for ball caps!

Give each family member his/her own **Sweater Bag** as a hamper for dirty socks. Wash and dry them in the bag.



- **RETRACTABLE CLOTHESLINE:** Ideal for small spaces or wet areas such as shower/tub, dorms, apartment, mud room, laundry room or craft room.
- **CLOTHESPINS:** Use with a clothesline or utility hooks for clothing, fabric or various craft/hobby items.

Laundry Tips:

- Wash whites, lights & darks separately whenever possible.
- Wash sheets & towels separate from clothing to keep lint off clothes.
- Inspect shirt fronts for stains and spot treat while loading washer.
- Read labels for care instructions. Most silk is best dry-cleaned.
- Over-drying causes static and makes fabric feel rough and stiff.
- Wrinkles? Warm clothes for 10 minutes in dryer, then hang promptly.

LINT REMOVAL

LINT ROLLERS & LINT SHAVERS: Keep fabrics looking new.

- **60 SHEET ROLLER:** Best value! Super sticky adhesive even works in cold climates.
- **MINI ROLLER:** 3-pack for travel
- **CRAFT ROLLER:** Ergonomic handle
- **REFILL SHEETS:** Fits the 60-sheet and craft roller handles.
- **HOME LINT ROLLER:** Napped fabric picks up lint & pet hair.



- **SWEATER COMB & LINT SHAVERS** remove fuzz & pill balls. Use jumbo size for large items like blankets.



- **DUAL LINT ROLLER:** Ideal for heavy duty jobs like picking up large crumbs and particles.
- **2-DIRECTIONAL LINT BRUSH:** Cleans quickly and conveniently for right or left-handed users.
- **RUBBER BRUSH:** Use dry to remove lint, dust and pet hair or wet — with or without detergents — for kitchen and bath tasks.

To remove pet hair from clothing faster & easier, use a static removal spray, then a lint roller.

