

Recycled Superhero Headquarters (NOT TO SCALE)

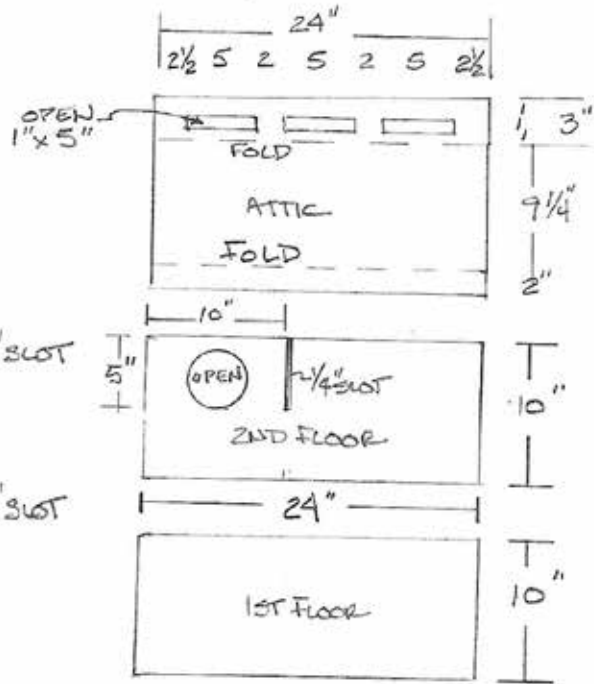
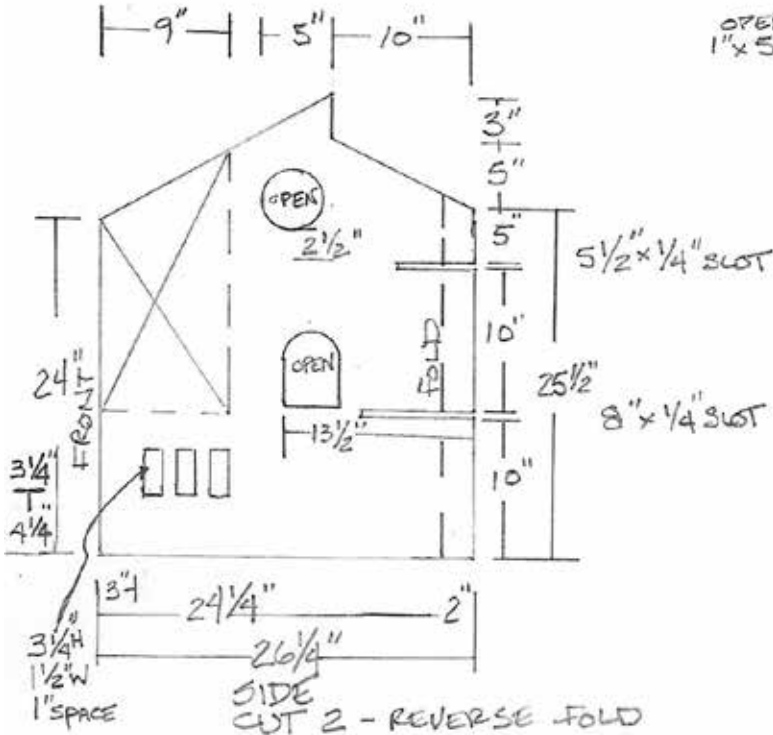
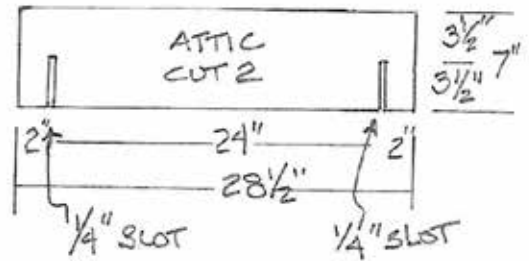
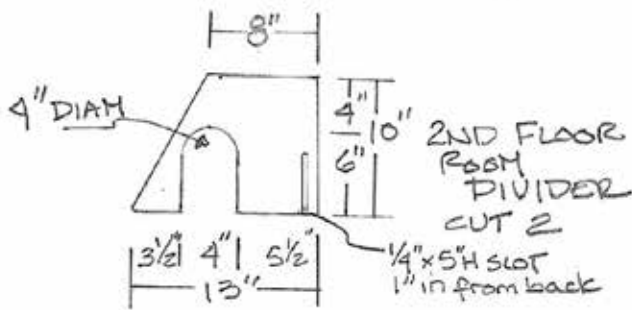
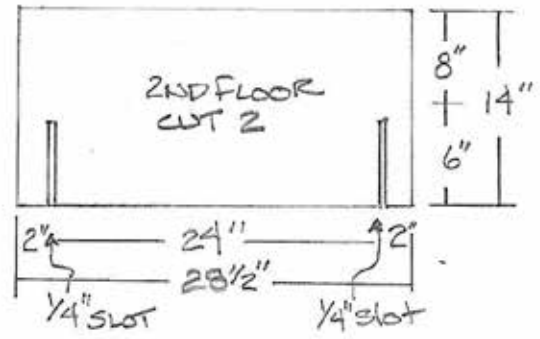
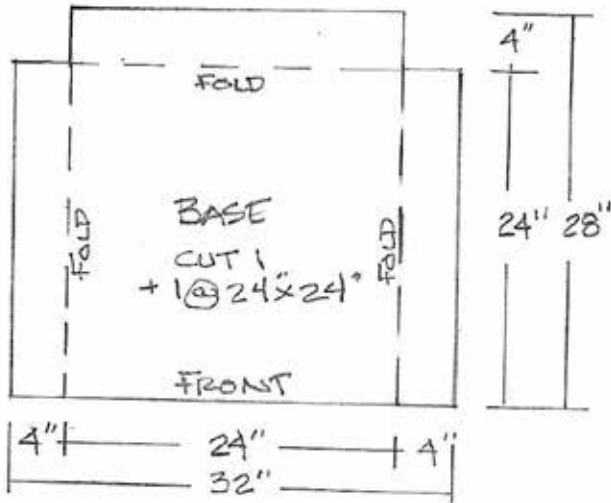

- SIDE CUT 2 - REVERSE FOLD**
- RIGHT SIDE FULL PANEL W/ DOOR OPENING (SAME AS DIVIDER)
  - LEFT SIDE NO DOOR / 3 LOWER WINDOWS / MINUS FRONT SECTION

**BACK CUT 2 EACH**

○ OPEN 4" DIAMETER

# Recycled Superhero Headquarters (NOT TO SCALE)

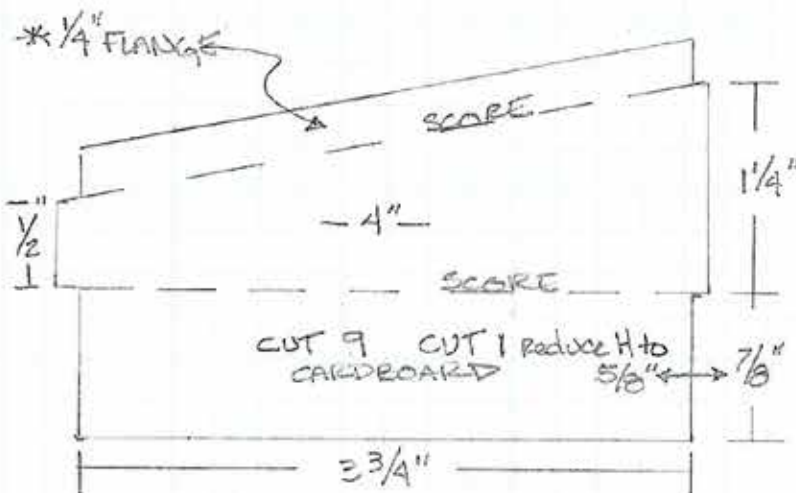
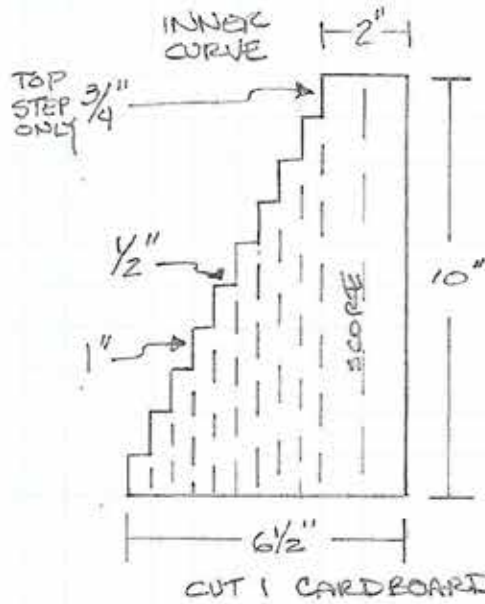
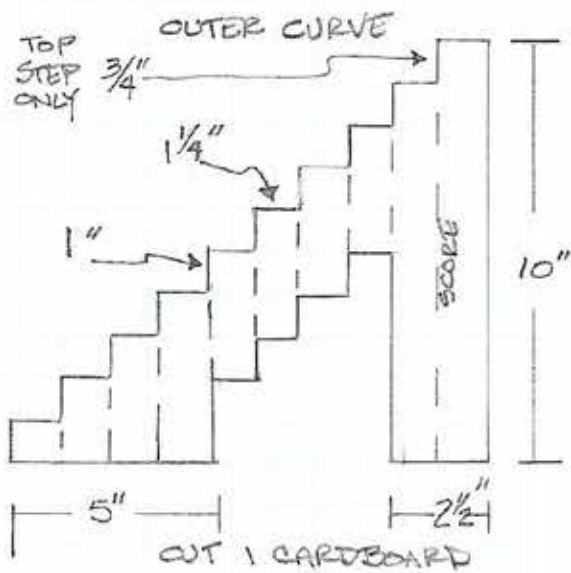

- \* ATTACH 1/4" FLANGE TO BACK OF UPPER STEP RISER
- TOP STEP DO NOT SCORE FLANGE
- TREAD GIVE TO UNDERSIDE OF 2ND FLOOR

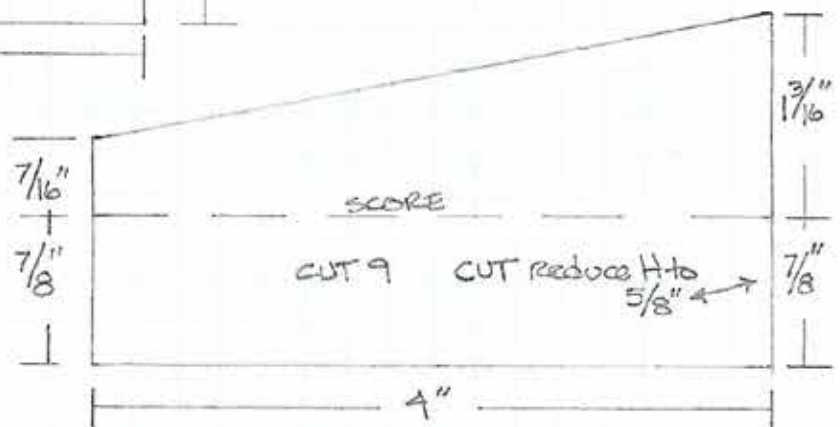

CURVED STAIRCASE

Recycled Superhero Headquarters (NOT TO SCALE)

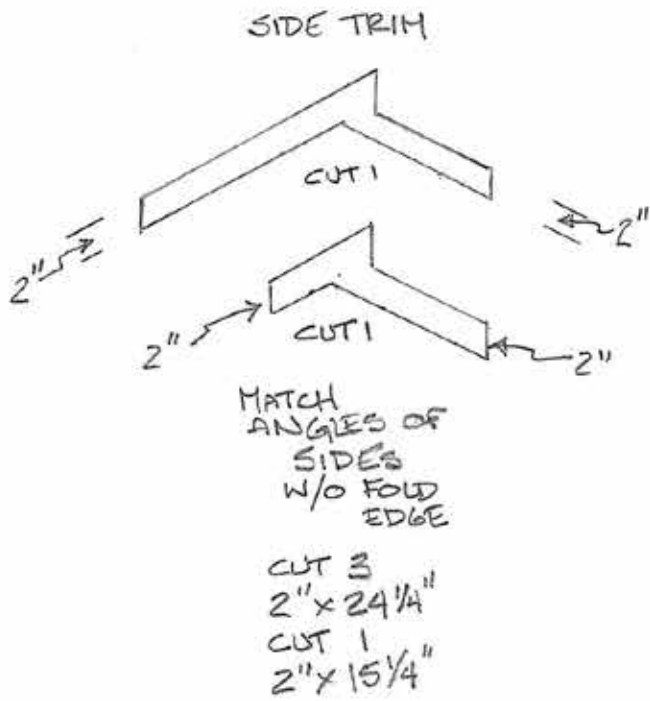

SECOND FLOOR TABLE

3/16" BLACK FOAM BOARD

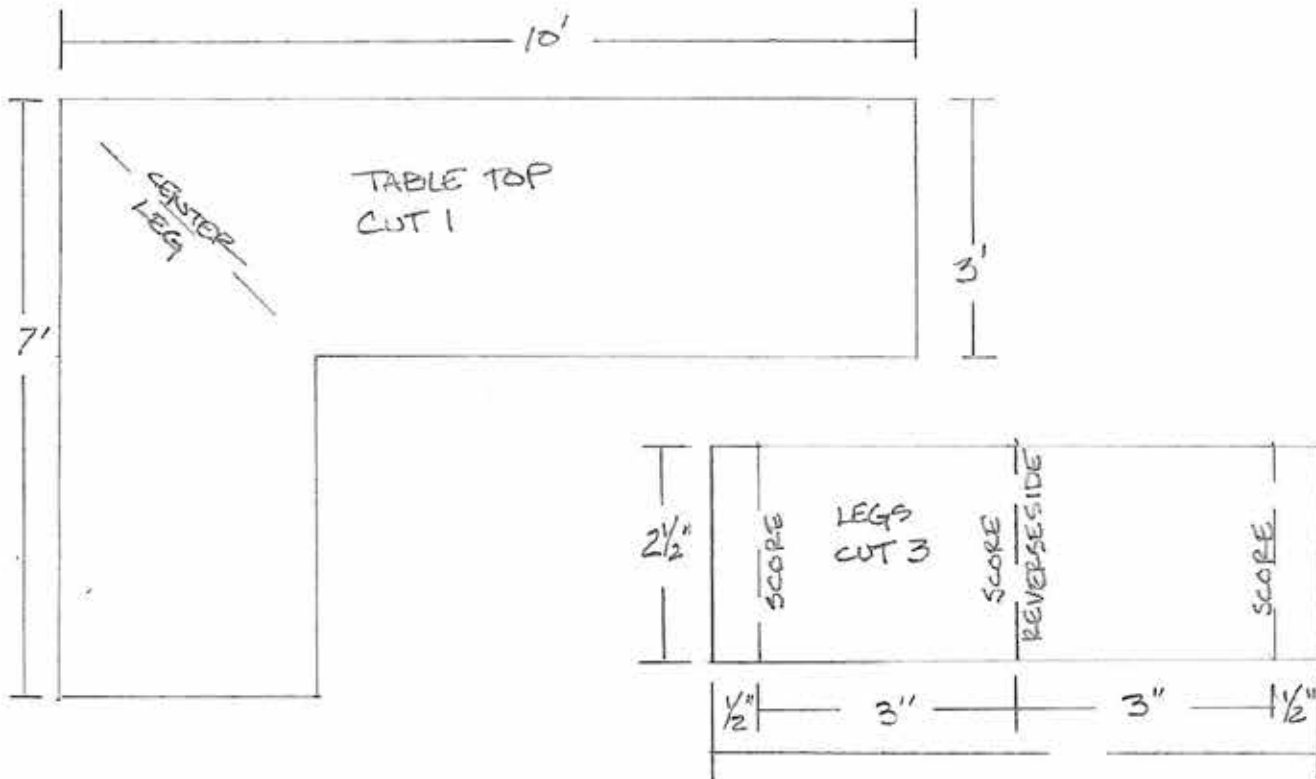

JOANN

Recycled Superhero Headquarters (NOT TO SCALE)

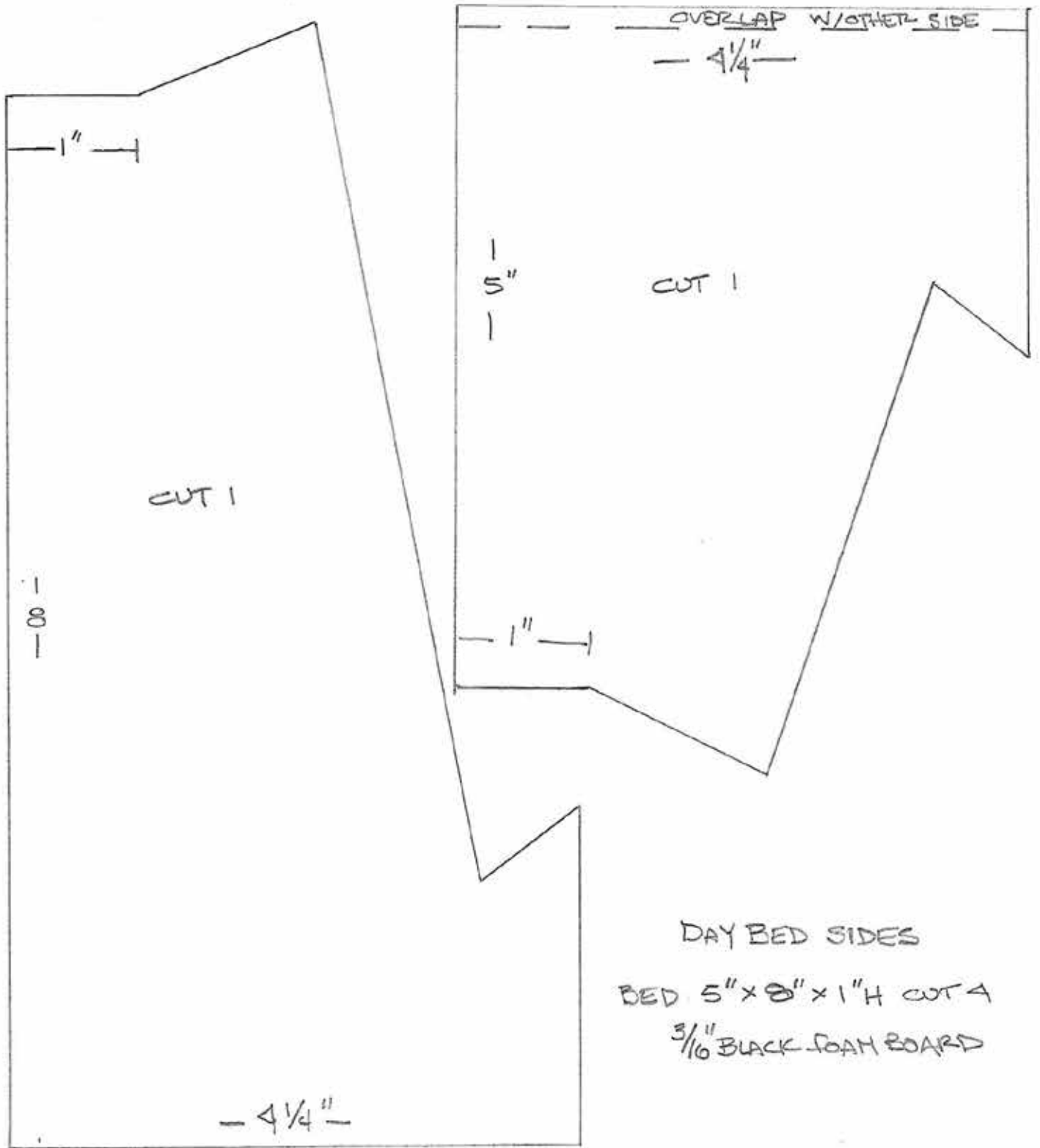

JOANN

Recycled Superhero Headquarters (NOT TO SCALE)

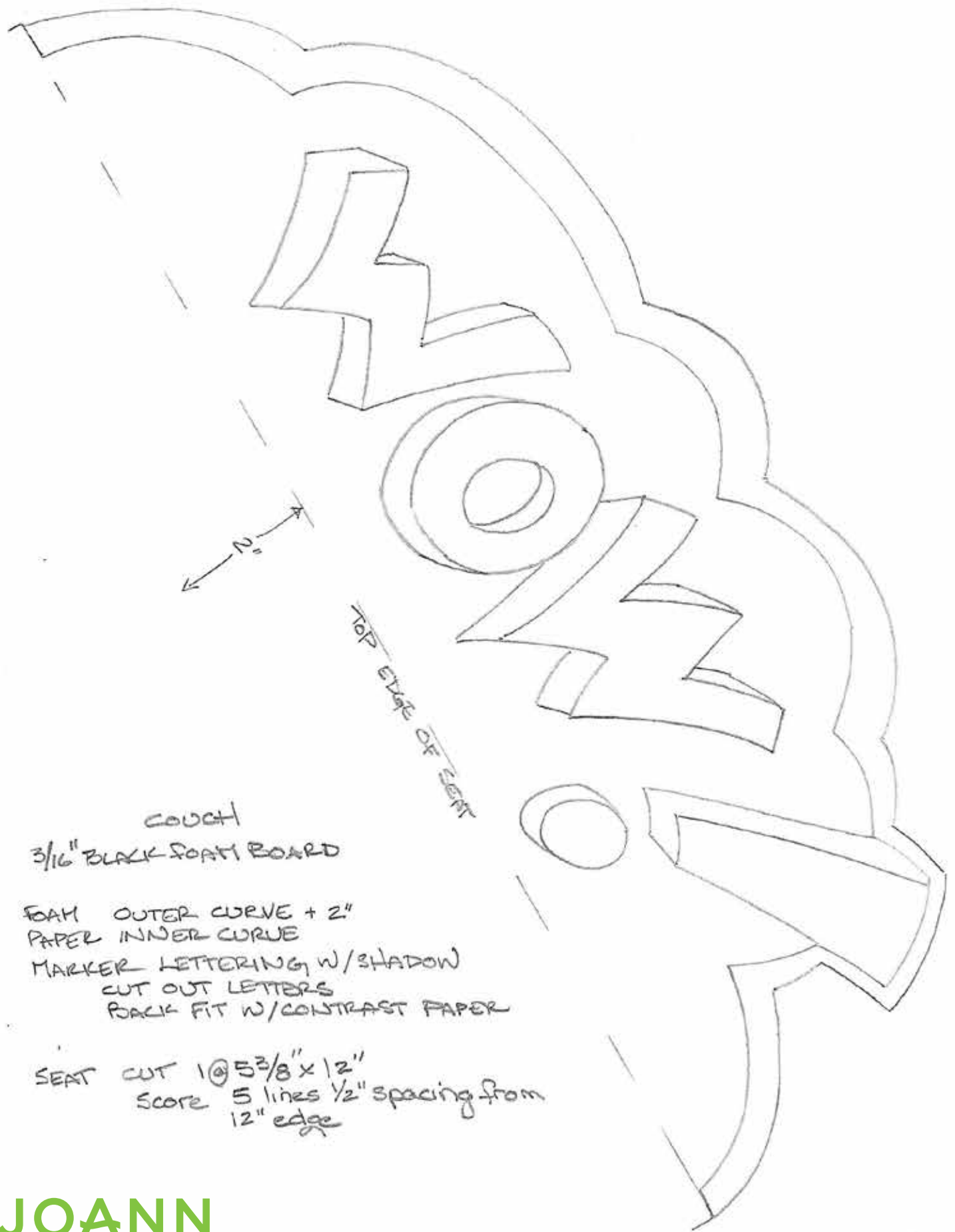

COUCH

3/16" BLACK FOAM BOARD

FOAM OUTER CURVE + 2"

PAPER INNER CURVE

MARKER LETTERING W/SHADOW

CUT OUT LETTERS

BACK FIT W/CONTRAST PAPER

SEAT CUT 1 @ 5 3/8" x 12"

SCORE 5 lines 1/2" spacing from  
12" edge

Recycled Superhero Headquarters (NOT TO SCALE)

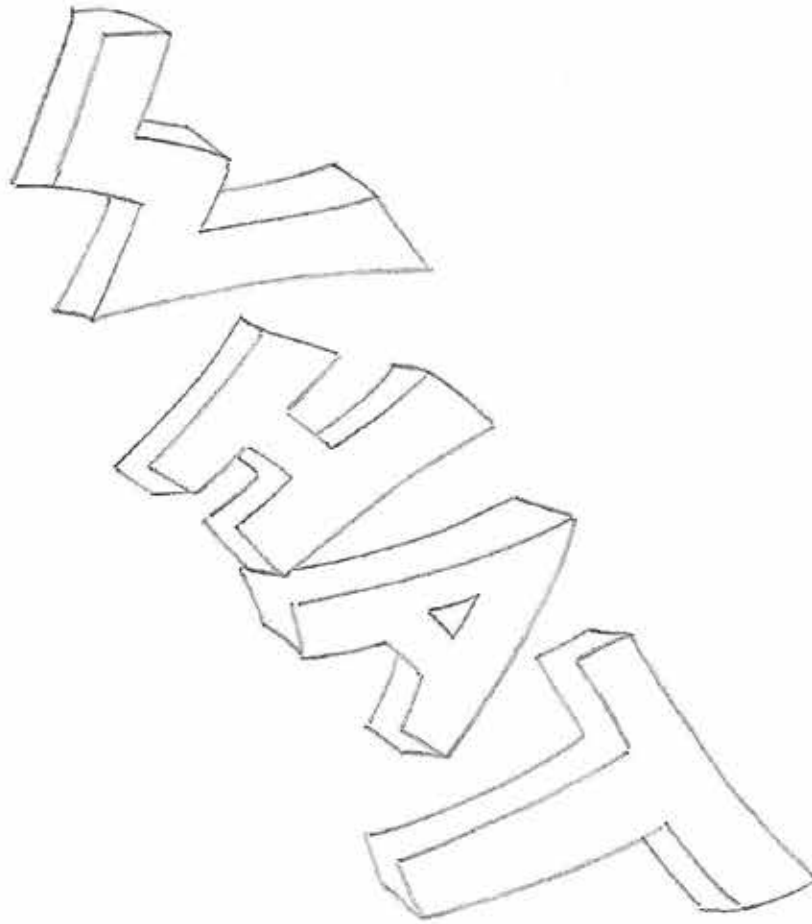

SAME AS  
WOW! COUCH

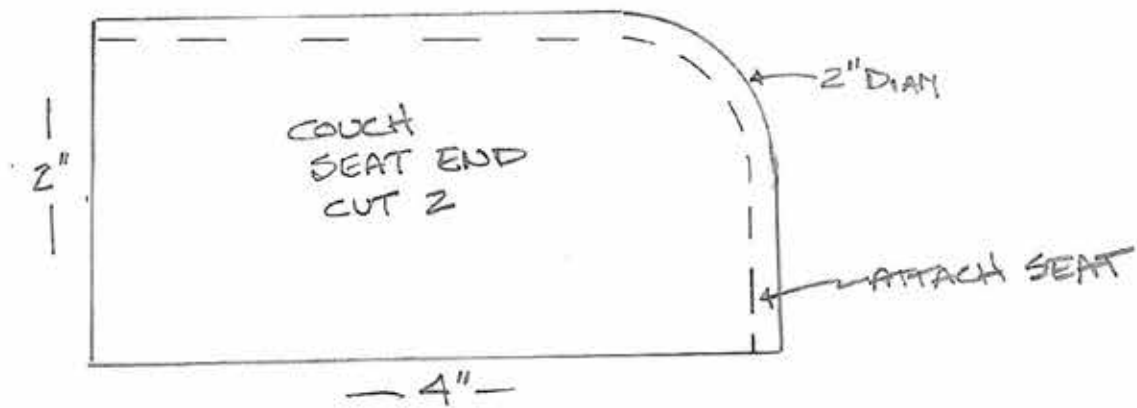

Recycled Superhero Headquarters (NOT TO SCALE)

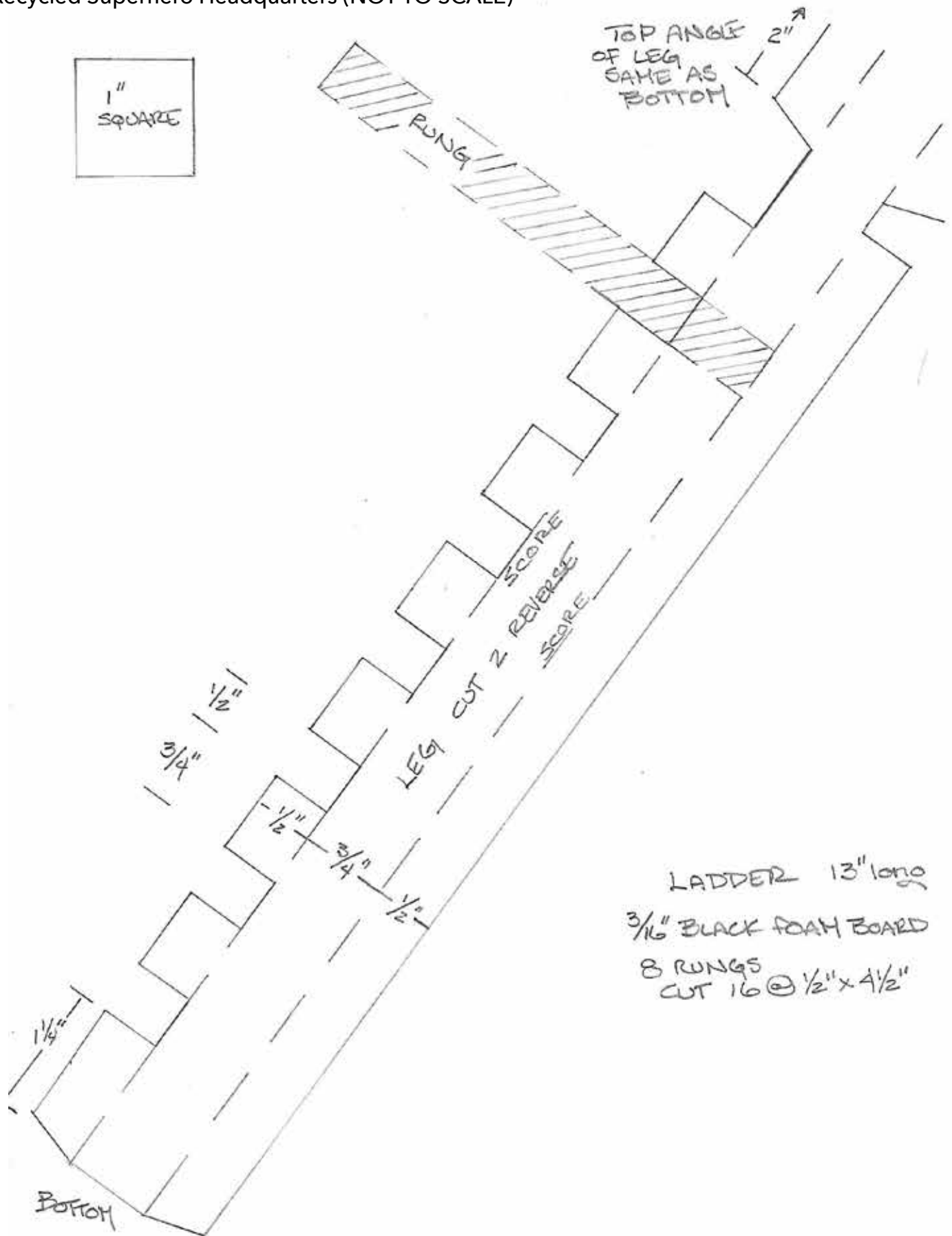

LADDER 13" long  
3/16" BLACK FOAM BOARD  
8 RUNGS  
CUT 16 @ 1/2" x 4 1/2"

JOANN

Recycled Superhero Headquarters (NOT TO SCALE)

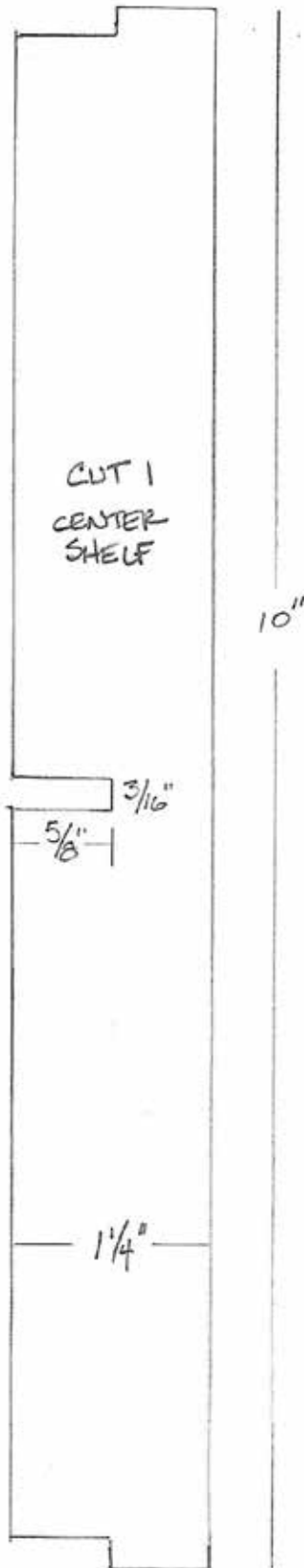

TOP SHELF: CUT 1 @  $\frac{1}{4}$ " x 10"  
BASE: CUT 1 @  $\frac{2}{4}$ " x 10"

ATTACH CENTER SHELF TO SLOTS  
IN 3 VERTICAL PARTS FIRST  
MARK CENTERS OF TOP SHELF +  
BASE TO LOCATE CENTER VERTICAL

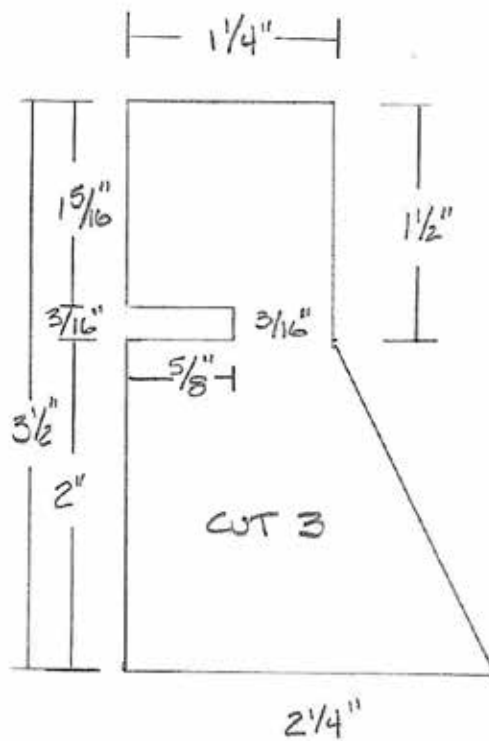

SHELVING